

Markham Village Arena Safety Plan

Address: 6041 Highway 7, Markham, ON

Phone: (905) 294-6111

Form updated October 2014

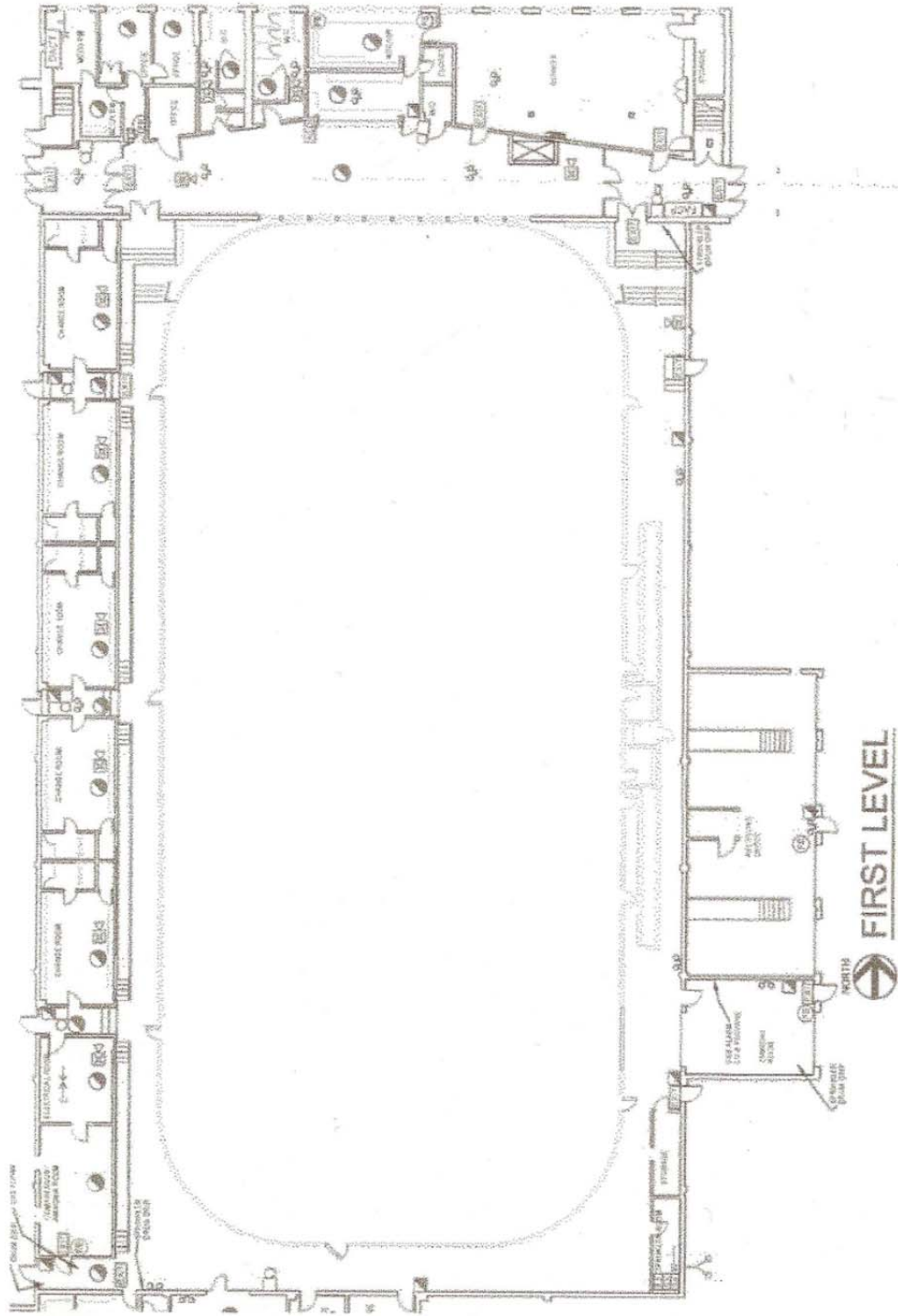

EQUIPMENT LOCATIONS

Please locate and identify areas on above map: i.e., first aid room, routes for ambulance crew, telephones, emergency exits, etc.

Legend

- Phone
- Exits
- + First Aid

Emergency 9-1-1

Non-Emergency numbers

- York Regional Police 905-773-1221
- York Region Public Emerg Med Svcs
905-830-4444 x4181
- Ambulance, YorkEMS 905-895-4511
- Markham FireDept & Emerg Services
M-F 8:30-4:30 905-415-7521
After Hours 905-477-2011
- Markham Stouffville Hospital
905-472-7000
- City of Markham Cust Service
905 477-5530

CHARGE PERSON

- Most qualified person available with training in first aid and emerg response
- Familiarize yourself with arena equipment
- Take control of emergency situation until medical personnel arrive
- Assess injury status of player

CALL PERSON

- Location of Emerg Telephone
- List of Emerg Phone numbers
- Directions to Arena
- Best route in/out of arena for ambulance crew
- Communicate with charge & control person

CONTROL PERSON

- Ensure proper room for charge person and ambulance crew
- Discuss emergency plan with 1) arena officials, 2) officials 3) opponents
- Ensure that the route for the ambulance crew is clear and available
- Seek highly trained medical personnel (i.e. MD, Nurse) to assist injured player if requested by charge person
- Discuss player's injury and status with parents

- Mark up the above rink schematic upon first seasonal entry into facility & keep a hard copy with you at all times.
- Assign a Charge, Call & Control person.